



e 602-II

Instruction manual



Delivery includes

- e 602-II
- pouch
- quick guide
- safety guide

Product overview

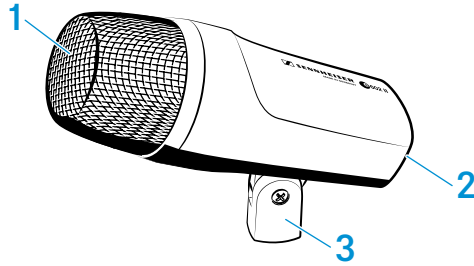

1. sound inlet basket
2. XLR-3 connector
3. integral stand mount



Installation

Attaching the microphone

- ▷ Screw the microphone's built-in mount onto a sufficiently stable microphone stand.

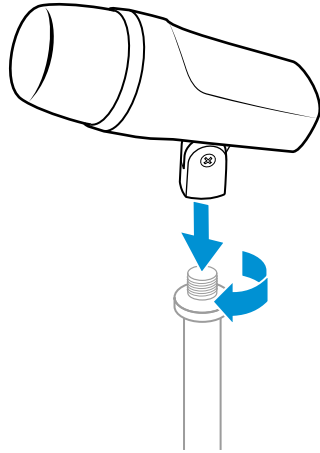

Connecting the microphone

- ▷ Connect the XLR-3 socket of the microphone cable (optional accessories) to the XLR-3 socket of the microphone.

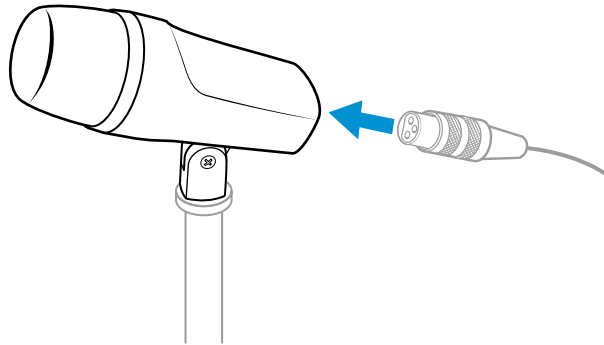



Operation

Positioning the microphone on a kick drum

▷ It is vital to observe the following notes:

Position	Resulting sound	Commentary
A	much attack little resonance dry	Position the microphone at a distance of a few centimeters from the batter head.
B	less attack much resonance smooth and voluminous	Position the microphone at the level of the resonant head.
C	less Attack	Position the microphone in the middle between the batter head and the resonant head.

i For less attack in all three positions, turn the microphone away from where the beater strikes.

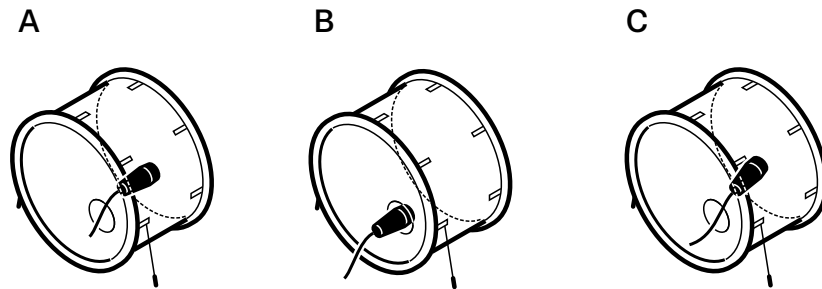

Positioning the monitor loudspeakers

▷ To prevent feedback and crosstalk, position your monitor loudspeakers in the angle area of the highest cancellation of the microphone (approx. 180°).

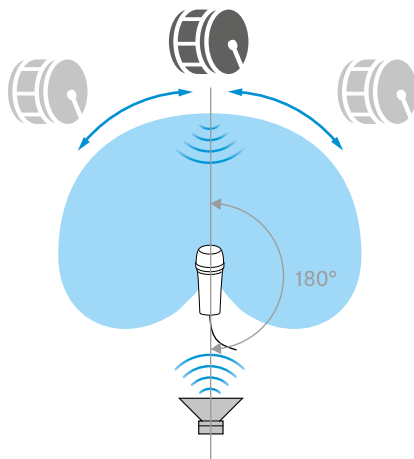



Cleaning and maintaining the e 602-II

CAUTION

LIQUIDS CAN DAMAGE THE ELECTRONICS OF THE PRODUCT!

Liquids entering the housing of the product can cause a short-circuit and damage the electronics.

- ▷ Keep all liquids away from the product.
 - ▷ Do not use any solvents or cleansing agents.
-
- ▷ Disconnect the products from the power supply system and remove rechargeable batteries and batteries before you begin cleaning.
 - ▷ Clean all products only with a soft, dry cloth.

Cleaning the sound inlet basket of the microphone module

- ▷ Unscrew the sound inlet basket.
- ▷ Remove the foam insert from the sound inlet basket.
- ▷ Use a slightly damp cloth to clean the sound inlet basket from the inside and outside.
- ▷ If necessary, clean the foam insert with a mild detergent or replace the foam insert.
- ▷ Dry the foam insert.
- ▷ Reinsert the foam insert.
- ▷ Replace the sound inlet basket on the microphone head and screw it tight.

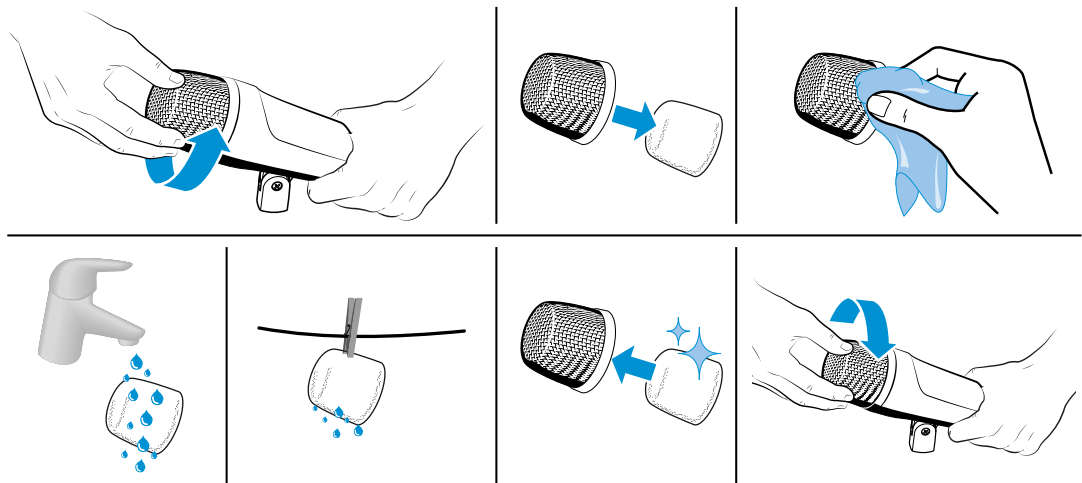



Specifications

Transducer principle	dynamic
Frequency response	20 - 16,000 Hz
Pick-up pattern	cardioid
Sensitivity (free field, no load)	0.9 mV/Pa (at 50 Hz) 0.25 mV/Pa (at 1 kHz)
Nominal impedance (at 1 kHz)	350 Ω
Min. terminating impedance	1 kΩ
Connector	XLR-3
Dimensions	∅ 60 mm, length 153 mm
Weight	318 g

Polar pattern

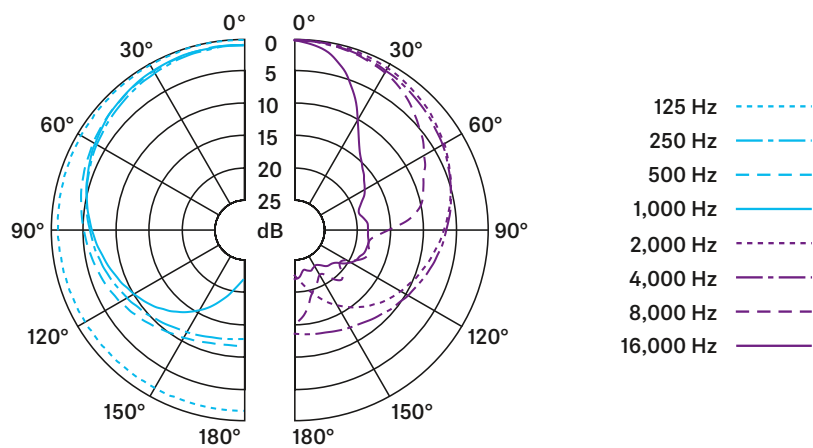

Frequency response

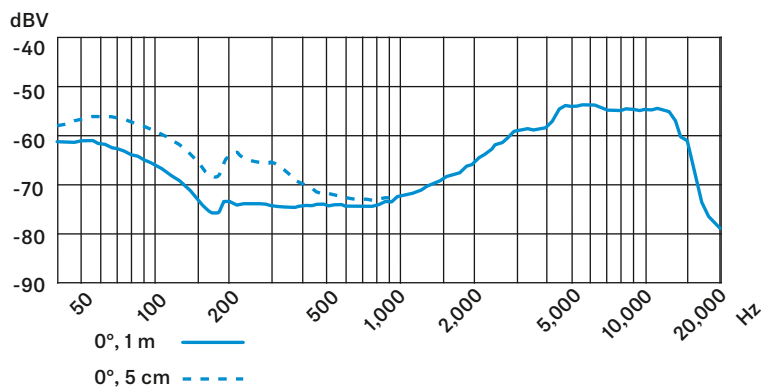



Connector assignment

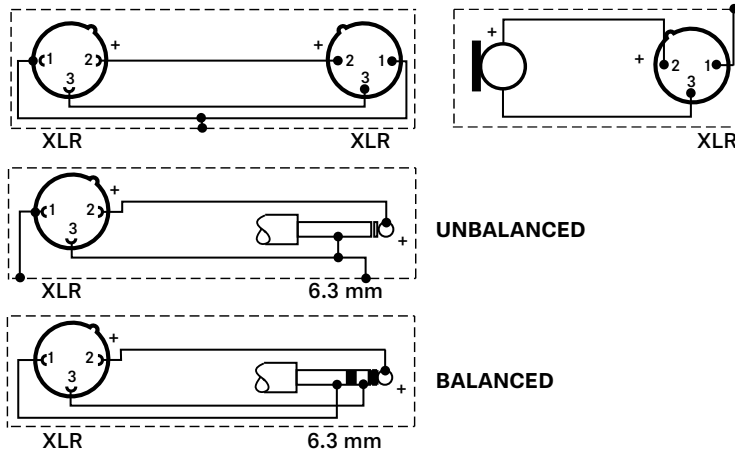

Overview of applications

● Primary application

● Secondary application



Model	Vocal	Speech	Instrument	Guitar	Violin	Piano	Drum	Microphone	Speaker	Headset	Intercom
e 602 II			●		●			●			●
e 604			●						●	●	●
e 608			●						●	●	●
e 609 silver						●			●	●	●
e 614		●	●	●	●				●		●
e 835	●	●									●
e 845	●	●									●
e 865	●	●									●
e 901							●	●			●
e 902						●	●	●			●
e 904			●						●	●	●
e 906					●				●	●	●
e 908			●						●	●	●
e 914		●	●		●	●			●		●
e 935	●										●
e 945	●										●
e 965	●	●			●						●



e 604

Instruction manual



Delivery includes

- e 604
- MZH 604 microphone clamp
- pouch
- quick guide
- safety guide

Product overview

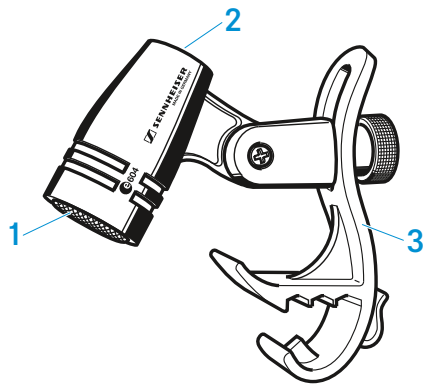

1. Sound inlet basket
2. XLR-3 connector
3. Microphone clamp



Installation

Attaching the microphone

- ▷ Fasten the holder to the microphone using the screw.

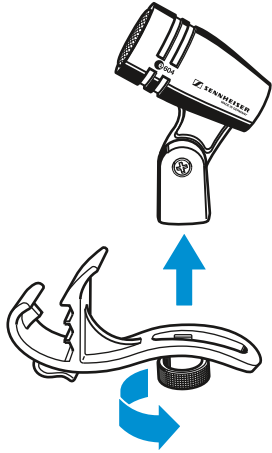

Connecting the microphone

- ▷ Connect the XLR-3 socket of the microphone cable (optional accessories) to the XLR-3 socket of the microphone.

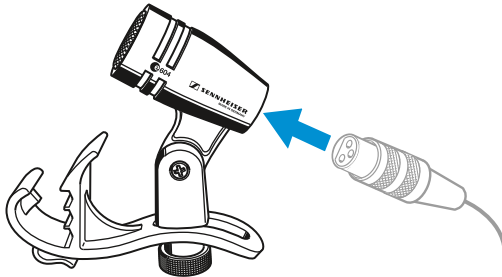



Operation

Positioning the microphone on a drum

- ▷ Use the microphone clamp to attach the e 604 to the rim of the drum.
- ▷ Position the microphone on the drum so that it is 3 to 5 cm above the drumhead.

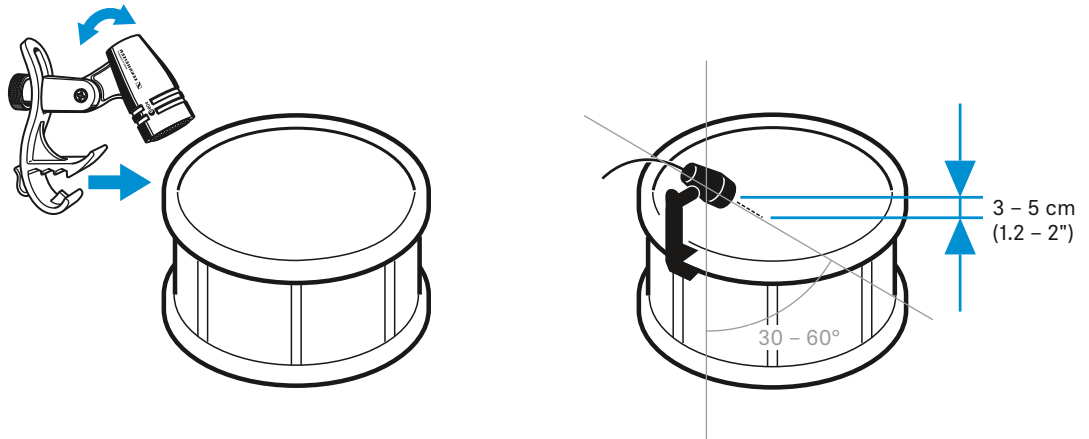

▷ It is vital to observe the following notes:

Position	Resulting sound	Commentary
A	More fundamental Little overtones	Position on the drum: 3 to 5 cm above the drumskin
B	Less fundamental Many overtones	The fundamental to overtones ratio can be adjusted by changing the angle of the microphone. The most balanced results are obtained at an angle of 30 to 60°.
C		Use of a second e 604 for picking up the bottom of the drumskin and the snares. NB: The lower microphone must be phase-reversed to avoid phase-cancellation effects due to the second microphone being on the other side of the drumskin.

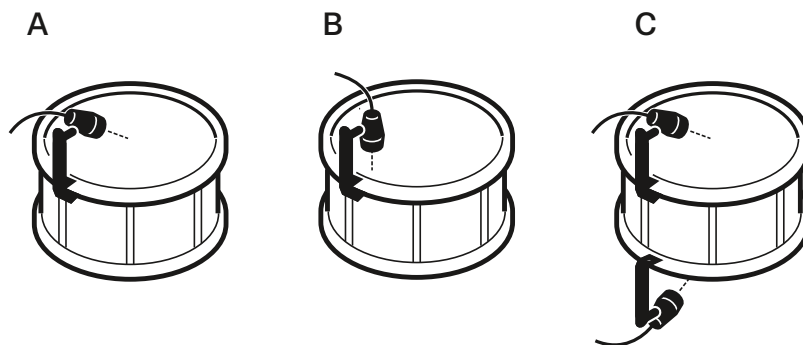



Positioning the monitor loudspeakers

- ▷ To prevent feedback and crosstalk, position your monitor loudspeakers in the angle area of the highest cancellation of the microphone (approx. 135°).

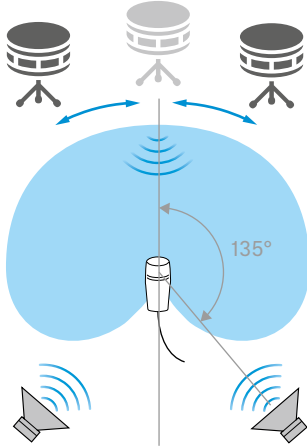

Cleaning and maintaining the e 604

CAUTION

LIQUIDS CAN DAMAGE THE ELECTRONICS OF THE PRODUCT!

Liquids entering the housing of the product can cause a short-circuit and damage the electronics.

- ▷ Keep all liquids away from the product.
 - ▷ Do not use any solvents or cleansing agents.
-
- ▷ Disconnect the products from the power supply system and remove rechargeable batteries and batteries before you begin cleaning.
 - ▷ Clean all products only with a soft, dry cloth.

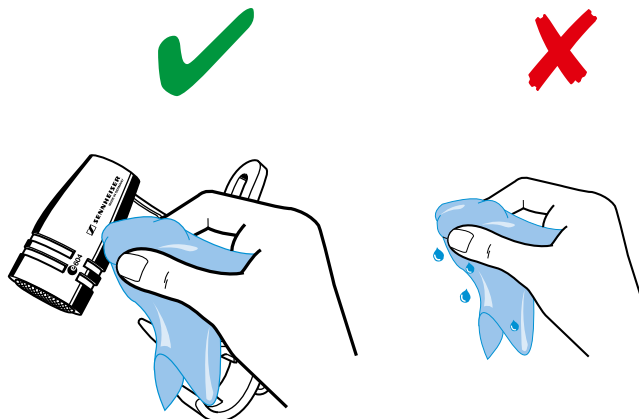



Specifications

Transducer principle	dynamic
Frequency response	40 - 18,000 Hz
Pick-up pattern	cardioid
Sensitivity (free field, no load)	1.8 mV/Pa
Nominal impedance (at 1 kHz)	350 Ω
Min. terminating impedance	1 k Ω
Connector	XLR-3
Dimensions	\varnothing 33 mm, length 59 mm
Weight	60 g

Polar pattern

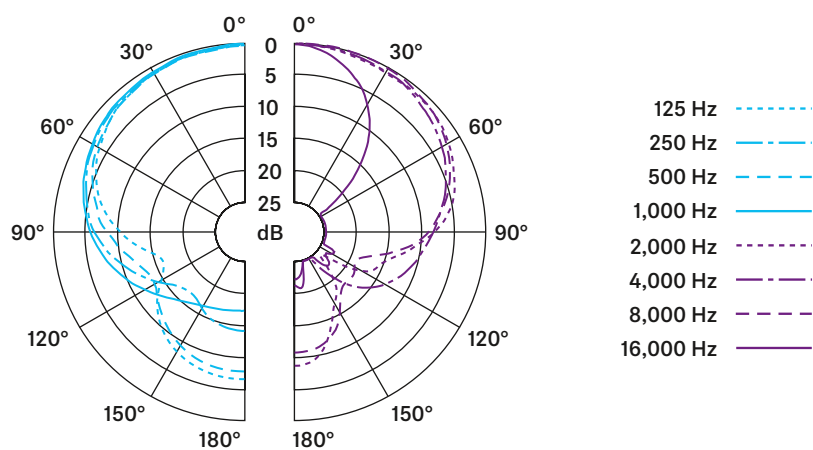

Frequency response

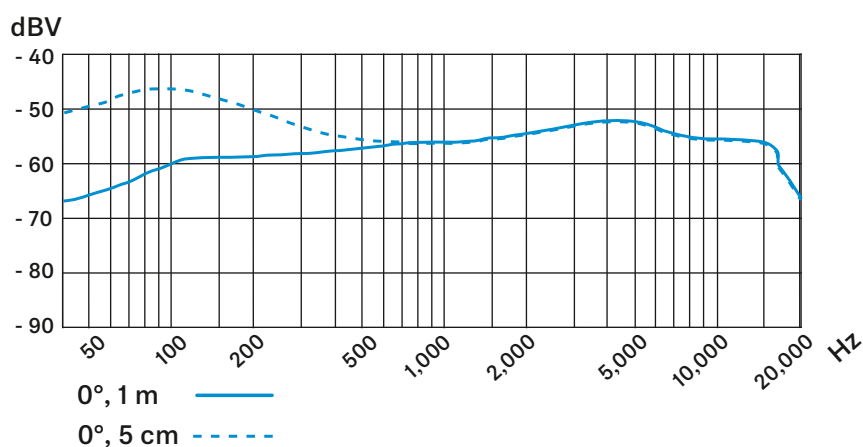



e 614

Instruction manual



Delivery includes

- e 614
- MZQ 100 microphone clamp
- pouch
- quick guide
- safety guide

Product overview

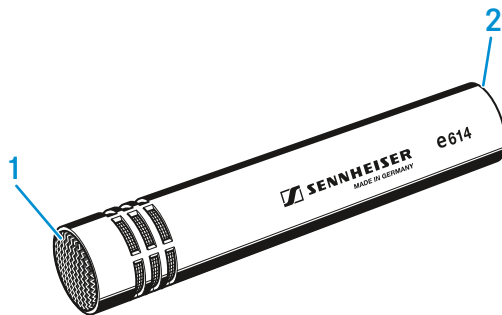

1. Sound inlet basket
2. XLR-3 connector



Installation

Attaching the microphone

- ▷ Screw the microphone clamp to a stand.
- ▷ Place the microphone with its back end into the microphone clamp.
- ▷ Orient the microphone together with the microphone clamp.

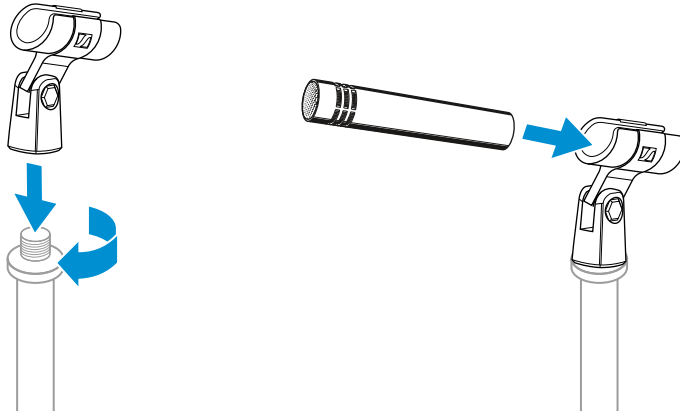

Connecting the microphone

- ▷ Connect the XLR-3 socket of the microphone cable (optional accessories) to the XLR-3 socket of the microphone.

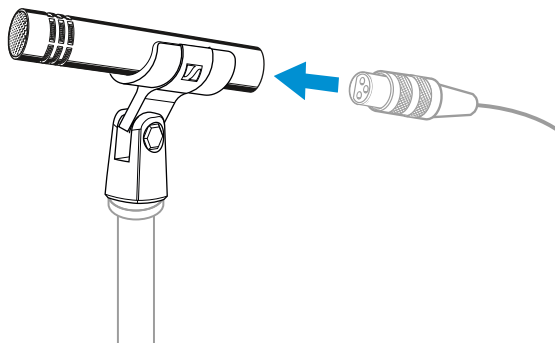

Using the windshield

- ▷ Place the MZW 64 (optional accessories) windshield over the microphone head.

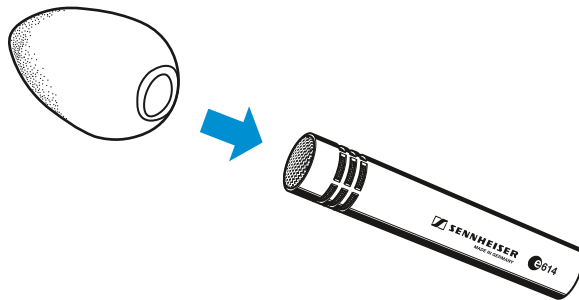



Operation

Positioning the microphone: Drums / Percussions

Attention: When closing the hi-hat, a strong air current is created on the edge. If the microphone is positioned too close to the edge, interfering noise due to the air current can occur.

▷ It is vital to observe the following notes:

Position	Resulting sound	Commentary
A	Natural, clear sound	Position the microphone a few centimetres above the outer edge of the hi-hat aiming down. If necessary, remove unwanted low-frequency signal portions by high pass filtering.
B	More fundamental, little overtones	

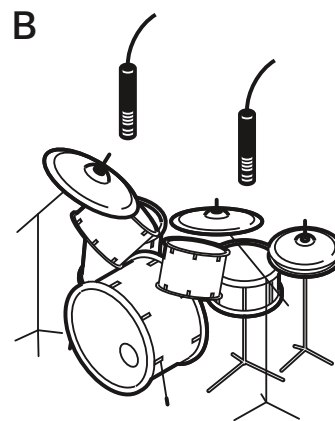
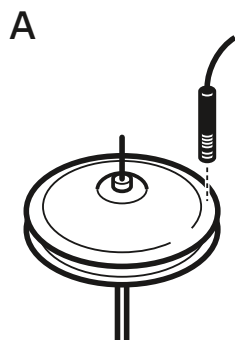

Positioning the monitor loudspeakers

▷ To prevent feedback and crosstalk, position your monitor loudspeakers in the angle area of the highest cancellation of the microphone (approx. 135°).

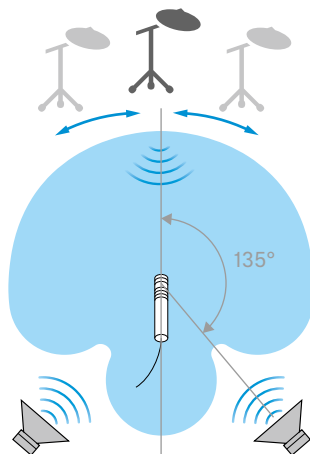



Cleaning and maintaining the e 614

CAUTION

LIQUIDS CAN DAMAGE THE ELECTRONICS OF THE PRODUCT!

Liquids entering the housing of the product can cause a short-circuit and damage the electronics.

- ▷ Keep all liquids away from the product.
 - ▷ Do not use any solvents or cleansing agents.
-
- ▷ Disconnect the products from the power supply system and remove rechargeable batteries and batteries before you begin cleaning.
 - ▷ Clean all products only with a soft, dry cloth.

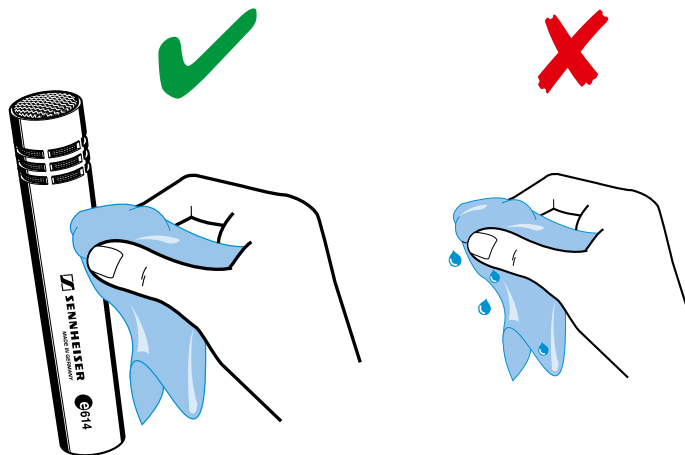



Specifications

Transducer principle	pre-polarised condenser microphone
Frequency response	40 - 20,000 Hz
Pick-up pattern	super-cardioid
Sensitivity (free field, no load)	3 mV/Pa
Nominal impedance (at 1 kHz)	50 Ω
Min. terminating impedance	1 k Ω
Max. sound pressure level (at 1 kHz)	139 dB
Equivalent noise level weighted as per CCIR 468-3	24 dB(A) 35 dB
Phantom powering	12 - 48 V
Connector	XLR-3
Dimensions	\varnothing 20 x 100 mm
Weight	93 g

Polar pattern

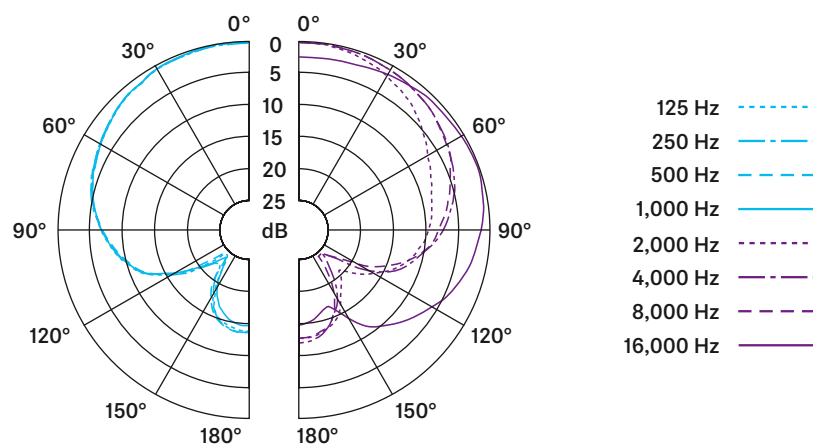

Frequency response

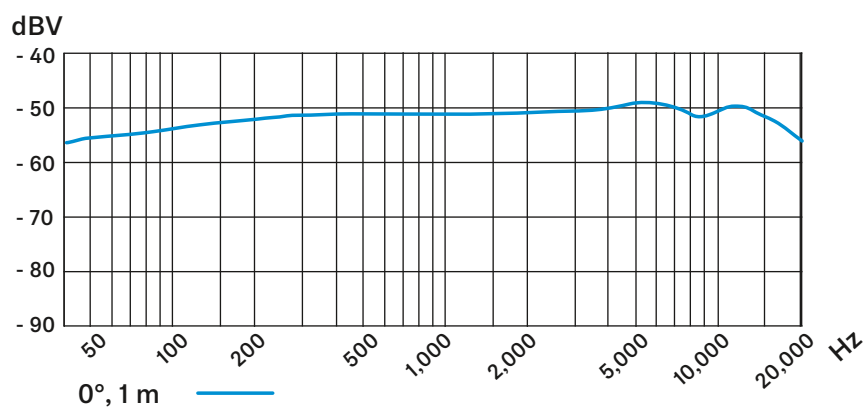



Connector assignment

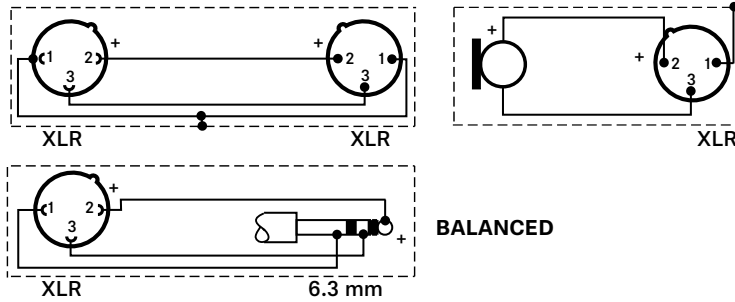

Overview of applications

- Primary application
- Secondary application

e 602 II				●		●		●	●		●					●	
e 604				●							●	●	●	●		●	
e 608				●							●	●		●		●	
e 609 silver							●				●	●	●	●		●	
e 614		●	●			●	●		●						●	●	
e 835	●	●														●	
e 845	●	●														●	
e 865	●	●														●	
e 901									●		●					●	
e 902								●	●		●					●	
e 904				●							●	●	●	●		●	
e 906							●				●	●	●	●		●	
e 908				●							●	●	●	●		●	
e 914		●	●			●	●		●						●	●	
e 935	●															●	
e 945	●															●	
e 965	●	●				●										●	●